



# PROVIDENCE PIPE PRODUCTS

## PRODUCT SPECIFICATION SHEET

NAME: EMT COMPRESSION COUPLING

### DESCRIPTION/FEATURES:

- Compression technology for firm grip and easy fastening.
- Heavy Steel walls and steel locknuts.
- Concrete tight.

### APPLICATION:

- Connect EMT conduit to boxes or enclosures.
- Suitable for indoor locations.

### MATERIAL:

- Steel (Zinc Plated)

### CODES & STANDARDS COMPLIANCE:

- UL514B
- RoHS Compliant



### PRODUCT PHOTO/LINE DRAWINGS:

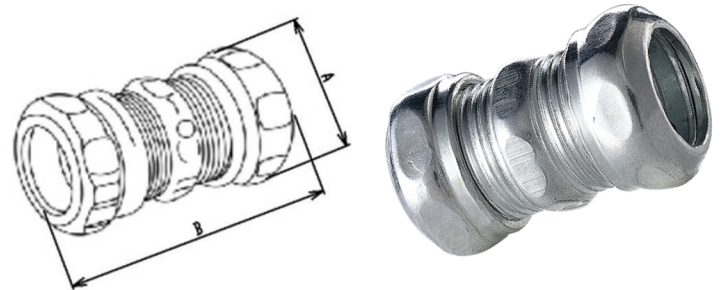

### SPECIFICATIONS:

Providence Part #	SIZE	DIMENSION A	DIMENSION B	PACKING		Weight per 100PCS
		(In.)	(in.)	INNER	OUTER	(Approx. lbs.)
P-ECC50-STL	1/2"	1.625	1.125	10	500	14.74
P-ECC75-STL	3/4"	1.75	1.375	10	250	21.3
P-ECC100-STL	1"	1.875	1.688	10	200	28.83
P-ECC125-STL	1-1/4"	2.25	2.063	10	100	46.5
P-ECC150-STL	1-1/2"	2.25	2.25	10	100	58.5
P-ECC200-STL	2"	2.375	2.75	10	50	75.71
P-ECC250-STL	2-1/2"	3.875	3.625	-	10	202.5
P-ECC300-STL	3"	4	4.25	-	6	231.53
P-ECC350-STL	3-1/2"	4.063	4.688	-	6	309.4
P-ECC400-STL	4"	4.938	5.188	-	6	391.4