



# PROVIDENCE PIPE PRODUCTS

## PRODUCT SPECIFICATION SHEET

NAME: EMT COMPRESSION CONNECTOR W/ INSULATED THROAT

### DESCRIPTION/FEATURES:

- Compression technology for firm grip and easy fastening.
- Insulated throat for stress free wire pulling.
- Heavy Steel walls and locknuts.
- Concrete tight.

### APPLICATION:

- Connects EMT conduit to boxes or enclosures.
- Insulated throat well suited for large scale jobs.
- Suitable for indoor locations.

### MATERIAL:

- Steel (Zinc Plated)
- Nylon

### SPECIFICATIONS:

### CODES & STANDARDS COMPLIANCE:

- UL514B
- RoHS Compliant



### PRODUCT PHOTO/LINE DRAWINGS:

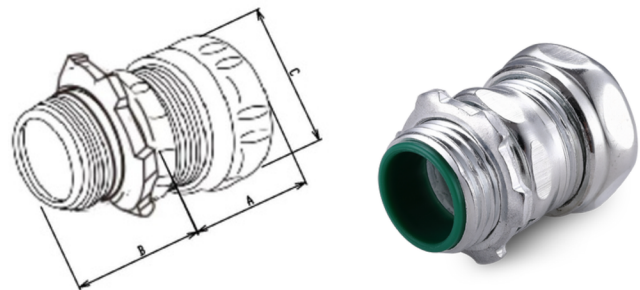

Providence Part #	SIZE	DIMENSION	DIMENSION	DIMENSION	PACKING		Weight per 100PCS (Approx. lbs.)
		A (In.)	B (in.)	C (in.)	INNER	OUTER	
P-ECCN50-I-STL	1/2"	1.051	0.515	1.125	10	500	10.89
P-ECCN75-I-STL	3/4"	1.177	0.515	1.375	10	250	17.1
P-ECCN100-I-STL	1"	1.195	0.547	1.688	10	200	22.9
P-ECCN125-I-STL	1-1/4"	1.39	0.699	2.063	10	100	40
P-ECCN150-I-STL	1-1/2"	1.39	0.719	2.25	10	100	50.4
P-ECCN200-I-STL	2"	1.567	0.739	2.75	10	50	67.4
P-ECCN250-I-STL	2-1/2"	2.445	0.901	3.625	-	10	178.1
P-ECCN300-I-STL	3"	2.555	0.979	4.25	-	10	211.3
P-ECCN350-I-STL	3-1/2"	2.87	1.023	4.688	-	10	288.1
P-ECCN400-I-STL	4"	2.803	1.055	5.188	-	10	341.9